

LAMEL PANEL INSTALLATION

Lamel Vertical Panel Z-Clips Installation

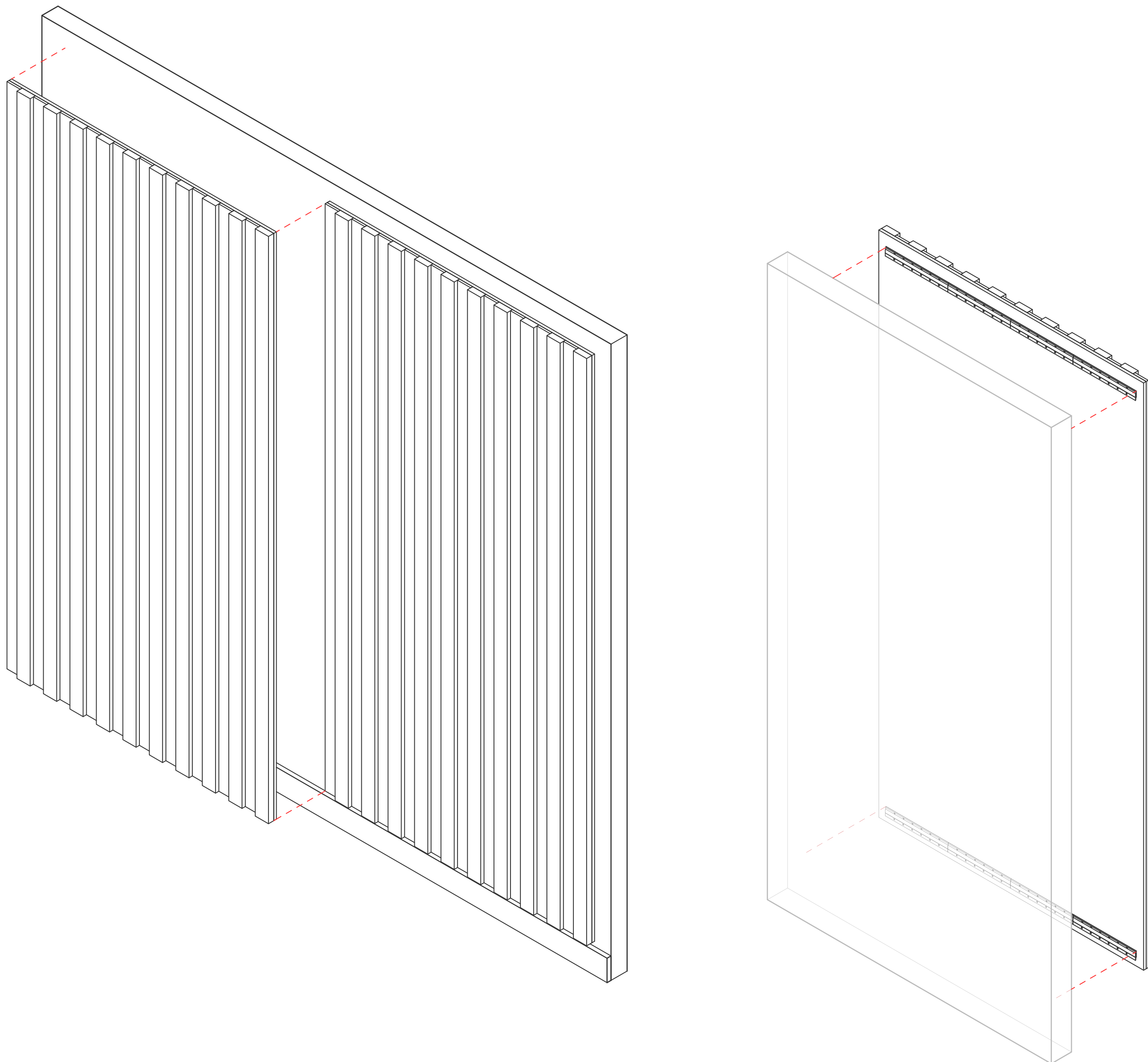

Z CLIPS

- Z-clips may be used with PET Panels by screwing Z-clips into surface and into the panel
- Use screws that will not extend past panel surface. Full width Z-clips are recommended, evenly spaced vertically on the panels, with clips placed starting 4-6" from top of the panel, and multiple Z-clips spaced regularly as needed to support the panel against potential impact
- To ensure panels lay flat, support panel weight from top full width Z-clip. It is recommended that middle and bottom Z-clips be installed with a 1/16" gap to allow for panel flex

LAMEL PANEL INSTALLATION

Lamel Horizontal Panel Z-Clips Installation

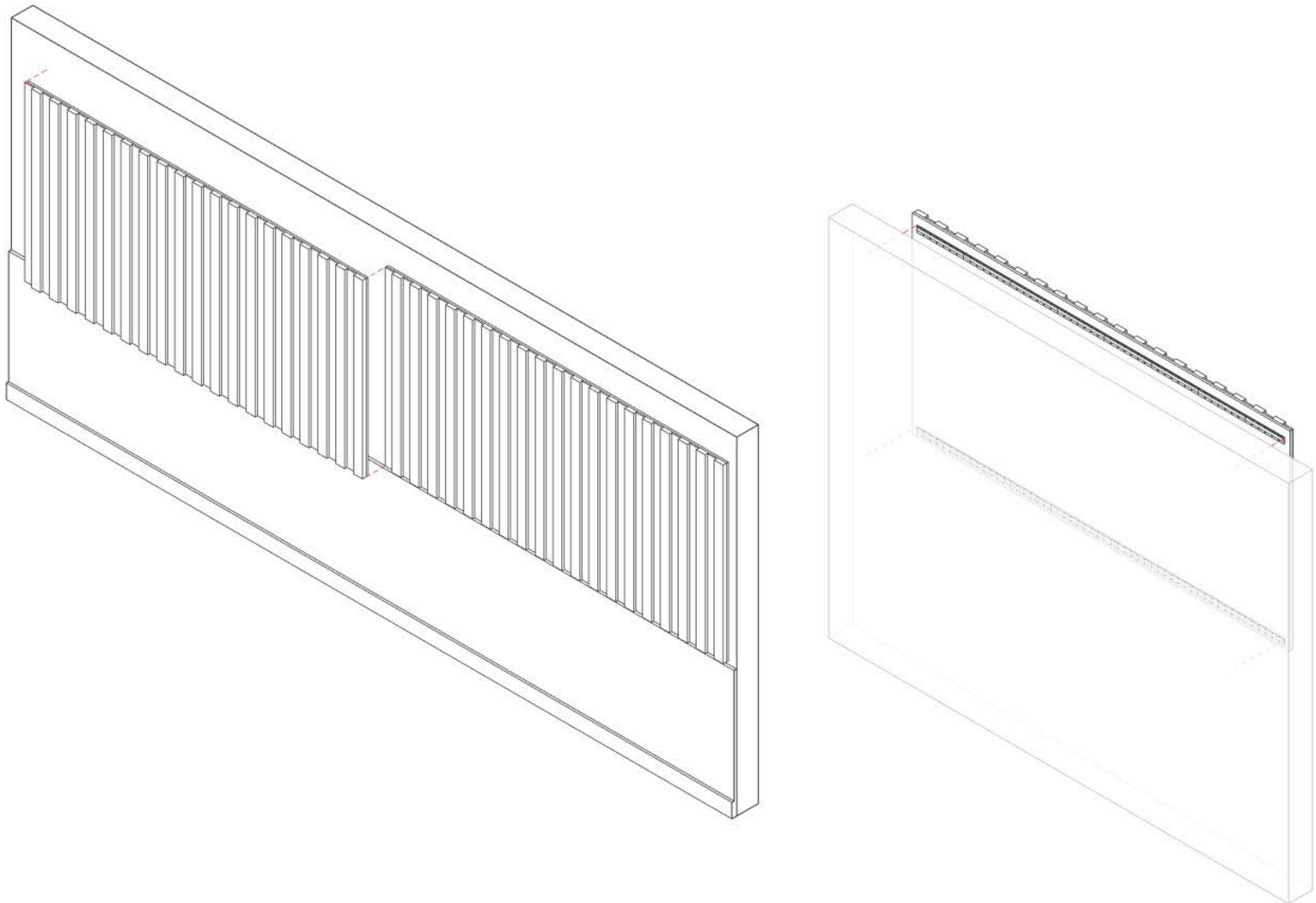

Z CLIPS

- Z-clips may be used with PET Panels by screwing Z-clips into surface and into the panel
- Use screws that will not extend past panel surface. Full width Z-clips are recommended, evenly spaced vertically on the panels, with clips placed starting 4-6" from top of the panel, and multiple Z-clips spaced regularly as needed to support the panel against potential impact
- To ensure panels lay flat, support panel weight from top full width Z-clip. It is recommended that middle and bottom Z-clips be installed with a 1/16" gap to allow for panel flex

LAMEL PANEL INSTALLATION

Lamel Horizontal Panel Z-Clips Installation

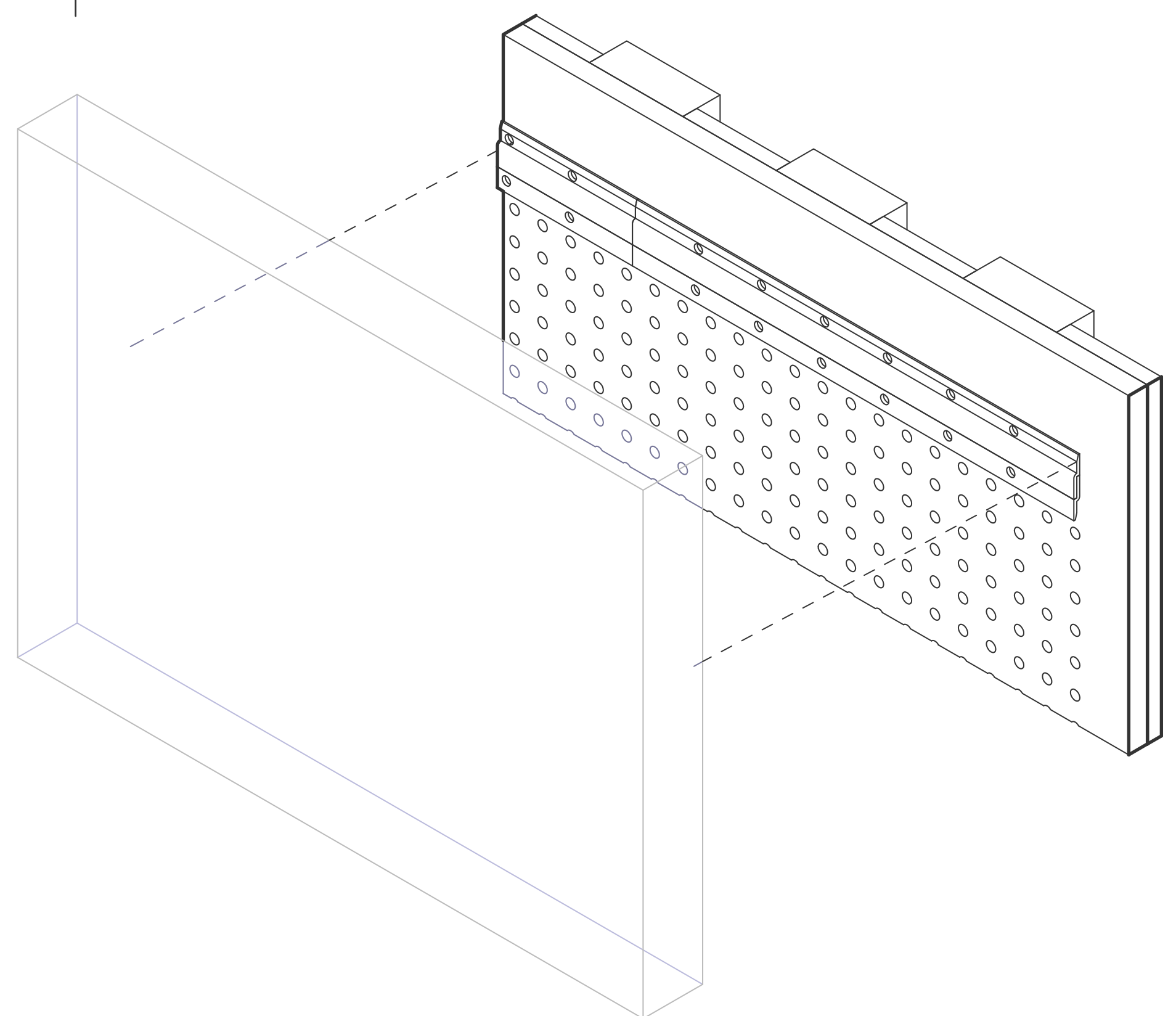
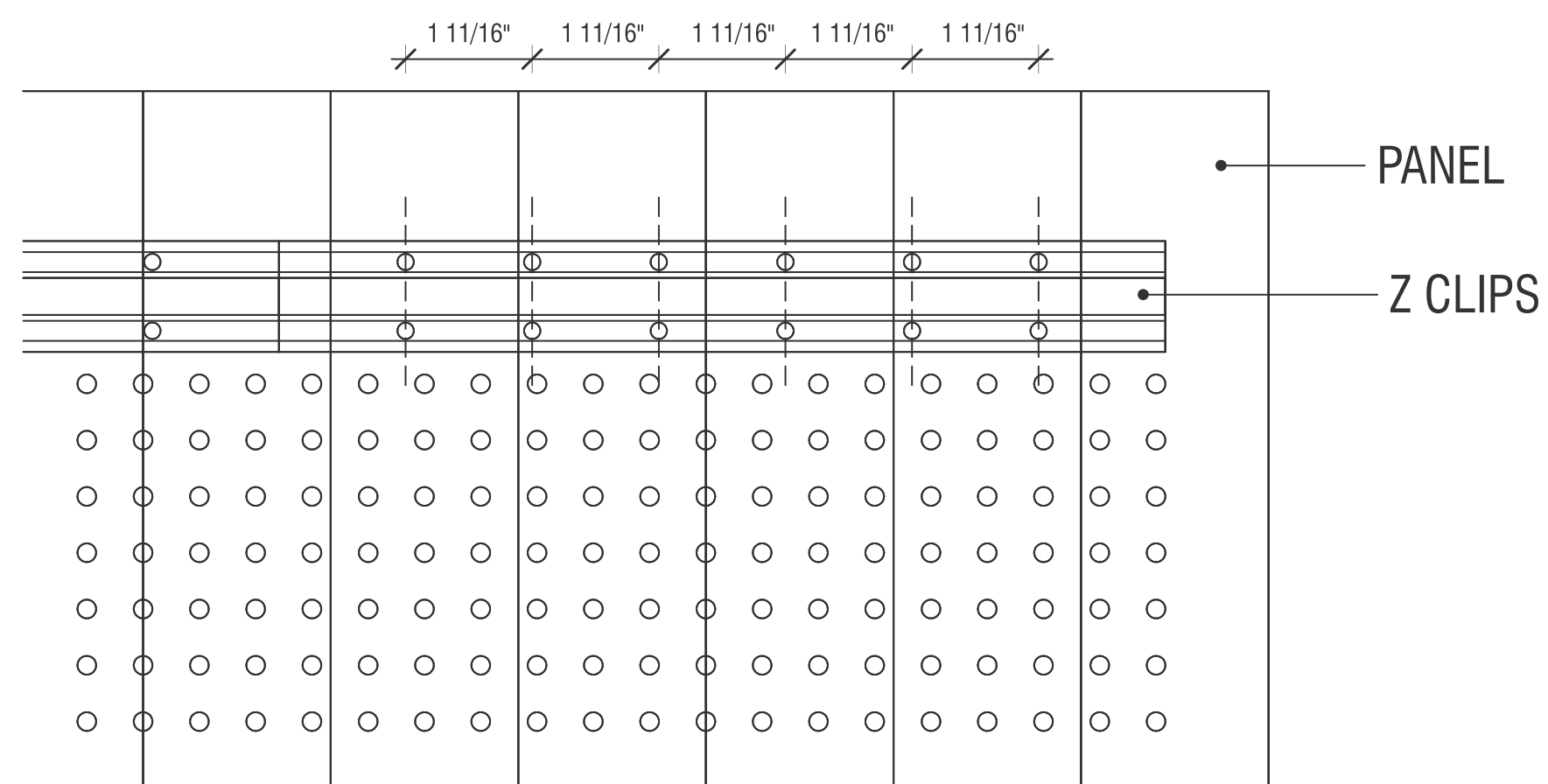

Z CLIPS

- Z-clips may be used with PET Panels by screwing Z-clips into surface and into the panel
- Use screws that will not extend past panel surface. Full width Z-clips are recommended, evenly spaced vertically on the panels, with clips placed starting 4-6" from top of the panel, and multiple Z-clips spaced regularly as needed to support the panel against potential impact
- To ensure panels lay flat, support panel weight from top full width Z-clip. It is recommended that middle and bottom Z-clips be installed with a $1/16"$ gap to allow for panel flex